



## CELL – BMZ 18650 11PM

## TECHNICAL INFORMATION

Lithium Ion Rechargeable Battery

### Name and Code

■ Cell Name: BMZ 18650 11PM

### Cell Shape and Weight

■ Cell Shape: cylindrical  
 ■ Weight: 38.5 g

### Safety Regulation

■ UN, IEC, UL

### Size (with plastic tube):

■ Diameter: 18.2 mm  
 ■ Length: 64.9 mm

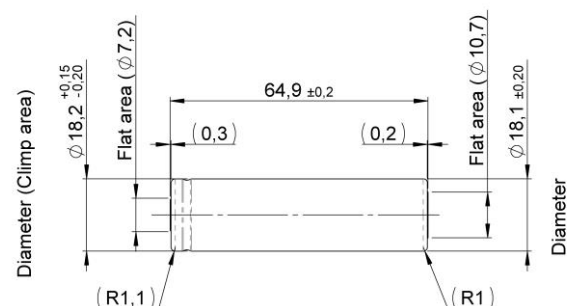

## ROBUST AND EXTREME SAFETY

- Charge Method: CC-CV
- Nominal Voltage: 3.2 V
- Maximum Charge Current: 1.50 A
- Maximum Charge Voltage: 3.65 A
- Charge Time: 2.5 h
- Ambient Temperature: 23°C

### Performance

(at room temperature, 2.0 V cut off)

Rated Capacity (0.2 C discharge)	1050 mAh	
Continuous Maximum Discharge Current	20.0 A	
Energy Density	199 Wh/l	
Allowable Environment Temperatures	Charging: 0°C – 60°C	Discharging: -20°C – 60°C
Extreme Temperatures with reduced lifetime and performance	Charging: 0°C – 60°C	Discharging: -40°C – 90°C
Internal Impedance	12-22 mΩ	measured by AC 1 kHz



**DISCHARGE LOAD CHARACTERISTICS**

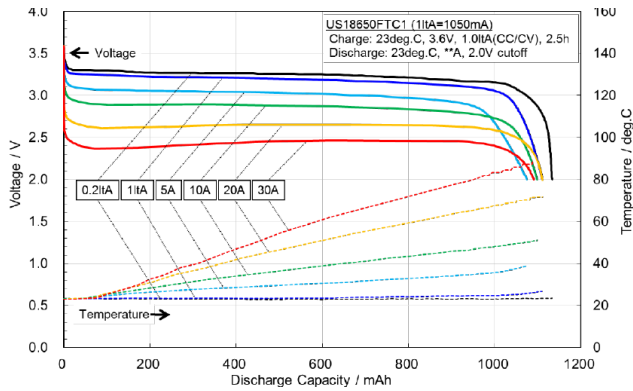

**STORAGE CHARACTERISTICS**

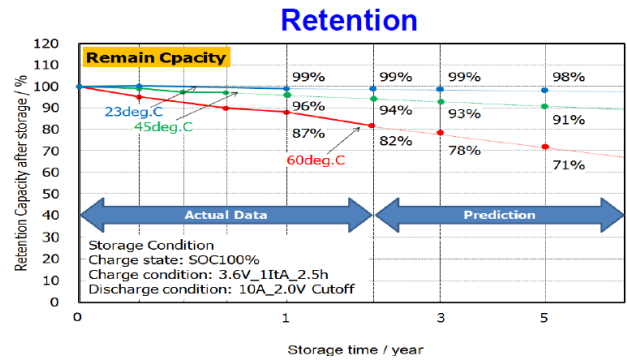

**STORAGE CHARACTERISTICS**

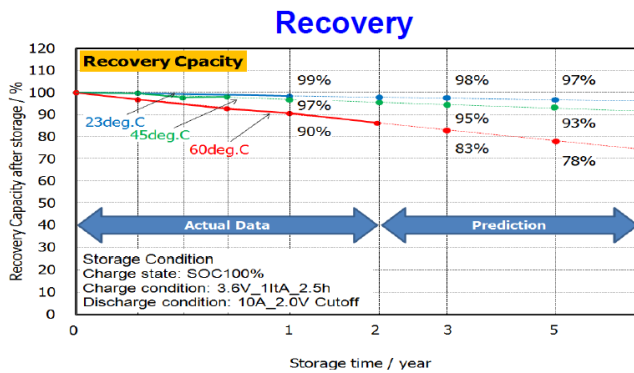

**DETERIORATION ESTIMATION**

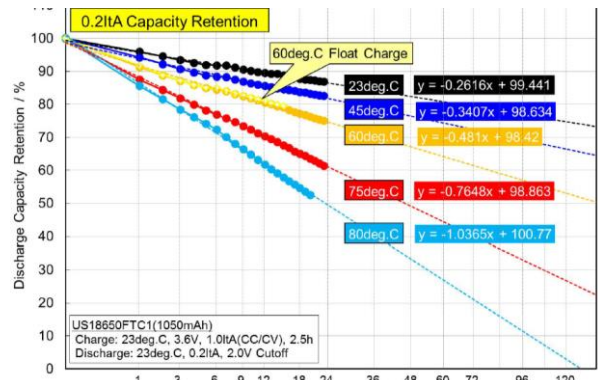

**DISCHARGE LOAD CURVE**

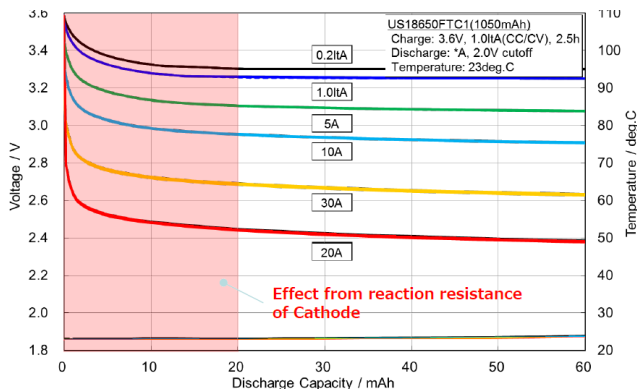

**DETERIORATION RATIO VS DCR: 1A/2A**

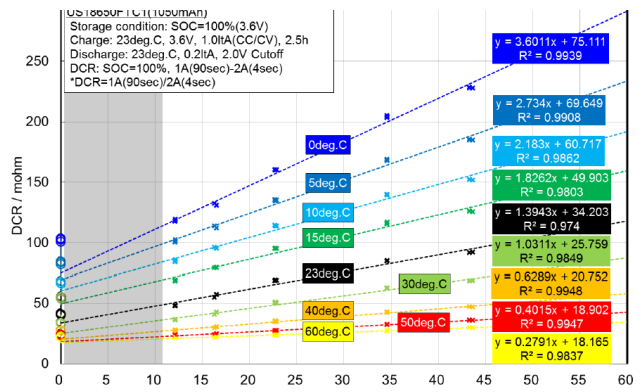

Data is for reference use only. Not guarantee value.

BMZ GmbH | Am Sportplatz 28-30 | 63791 Karlstein am Main | Germany

Phone +49 61 88-9956-0 | Fax +49 61 88-9956-900 | mail@bmz-gmbh.de | www.bmz-gmbh.de